

REVISION HISTORY

REV	DESCRIPTION	DATE	APPROVED
-----	-------------	------	----------

NOTES:

1. INTERPRET DIMENSIONS AND TOLERANCES PER ASME Y14.5M-1994
2. FACESTOCK: THE BRADY COMPANY B-624, OR EQUIVALENT
3. ADHESIVE: 3M EMTECH FS182 OR 3SIGMA PE18 OR APPROVED EQUIVALENT
4. TEXT SIZE TO BE 36 PT ARIAL NARROW
5. REFERENCE ART MASTER 4824591418
6. MARKINGS SHALL NOT BE VISIBLY DEGRADED TO THE UNAIDED EYE
AFTER THE FOLLOWING TREATMENTS:
- SCRATCHING 10 TIMES WITH A FINGERNAIL.
- RUBBING WITHOUT UNDUE PRESSURE FOR 15 SECONDS WITH A
SOFT BRISTLE TOOTH BRUSH WHILE WETTED WITH METHYLATED SPIRITS.

B

B

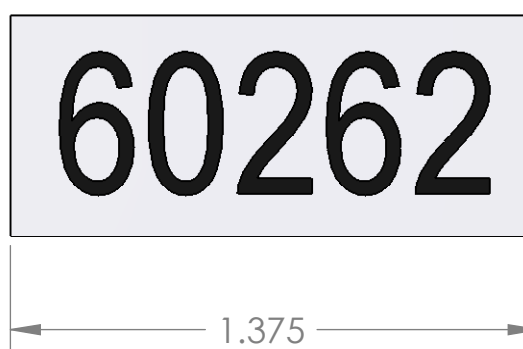

A



UNLESS OTHERWISE SPECIFIED
DIMENSIONS ARE IN INCHES, TOLERANCES ARE
.X ± .032 .XX ± .015 .XXX ± .005
ANGLES ± 1/2°
INTERPRET DIM AND TOL PER ASME Y14.5M-1994

THIRD ANGLE PROJECTION

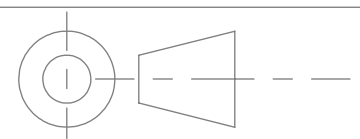

CONTRACT NO.
GS23F0011L

APPROVAL	DATE
----------	------

DRAWN C WILKINS	15-FEB-07
--------------------	-----------

CHECKED	
---------	--

ENGINEER	
----------	--

NATIONAL LIBRARY SERVICE
FOR THE BLIND AND PHYSICALLY HANDICAPPED
THE LIBRARY OF CONGRESS

TITLE
LABEL, MAILING CONTAINER BOOK NUMBER

SIZE B	DWG NO 4824591402	REV 1.4
-----------	----------------------	------------

SCALE 2:1 DO NOT SCALE DRAWING SHEET 1 OF 1